

## High Efficiency FCOB LED Strip With White Glue

Ref.: BL-FCOBW-160-24V-10mm-C-XXK

**(Every LED can be cut)**

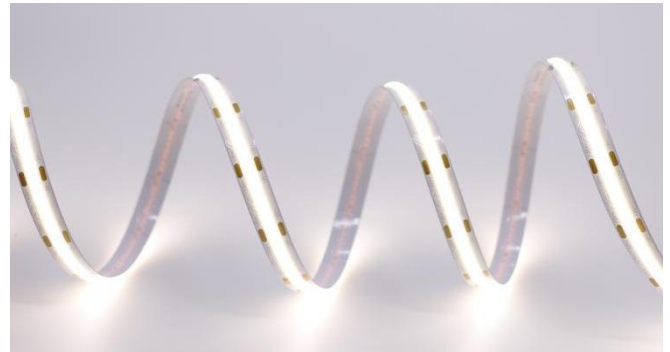
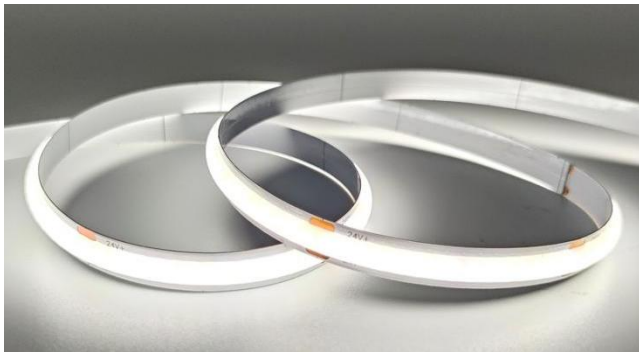

Product Description	HIGH EFFICIENCY FCOB LED STRIP WITH WHITE GLUE
Working Voltage	DC 24V
LED Quantity	320 LEDs / Meter
Light Efficiency	105~115LM/W
CRI	Ra>90
PCB Width	10mm
Light Color	<b>2700K</b> <b>3000K</b> <b>4000K</b> 6000K
IP Rate	IP20、IP67

**Product description:**

- ▶ Adopt brand LED chip,high brightness,low light decay, lifespan more than 25000 hours
- ▶ Color:2700K、3000K、4000K、6000K ;
- ▶ All of materials are accord with RoHS standards
- ▶ Easy to install and preserve;can be bent freely; with 3M adhesive tape on the backside
- ▶ High color efficiency, uniform illumination
- ▶ beam angle 180°,
- ▶ IP20--- non-waterproof

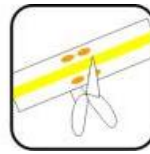
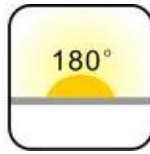

**Application:**

- ▶ Letter signage backlight
- ▶ Building Decoration
- ▶ Auditorium walkway lighting
- ▶ Advertising signs, light box lighting
- ▶ Landscape decoration



**Electrical-optical characteristics:**

10mm	Color	LEDs Type	Beam angle(°)	Voltage (DC)	RA	Power (W/M)	LM/W (avg.)	LM/M	Min. cut/mm
BL-FCOBW-160-24V-10 mm-C	2700K	FCOB	180	24V	Ra>90	15W ± 10%	105	1575	12.5
	3000K						110	1650	12.5
	4000K						115	1725	12.5
	6000K						115	1725	12.5

**Attention:**

- 1, Electrical parameters are standard one meter testing
- 2, error allow 10%
- 3, IP protection process will lead to changes in size, color temperature and luminous flux

**Dimension:**

24V | 10mm

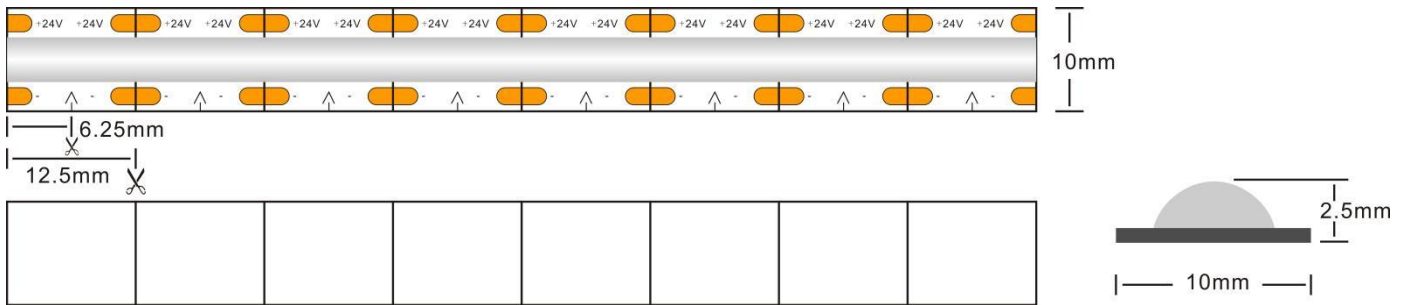

**Absolute maximum ratings (TA=25°C):**

Parameter	Symbol	Max Value	Unit
Forward voltage	VF	24	V
Antistatic Ability	ESD	2000	V
Working temperature	Topr	-20 – 80	°C
Storage temperature	Tstg	-40 – 100	°C

**Beam angle:**

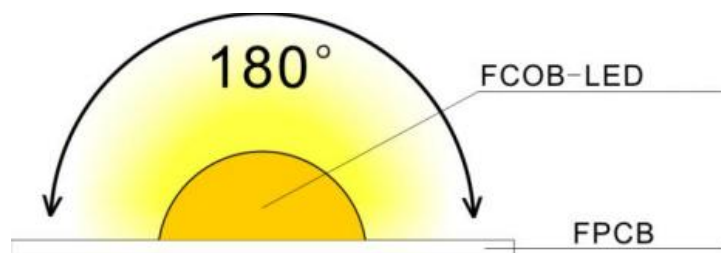

**Color Bin Limits**

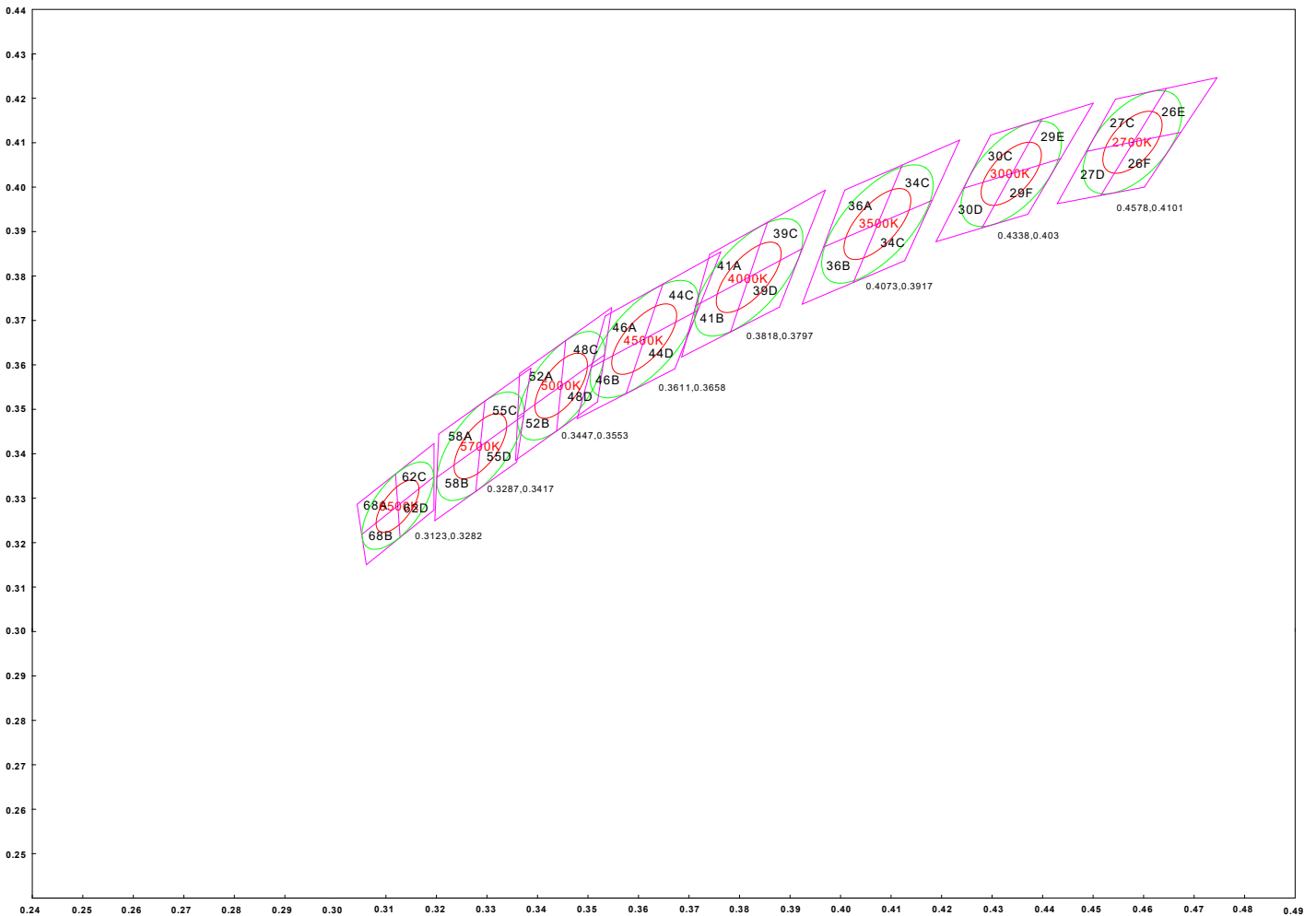

**[Color Ranks at VF=24V, Ta=25°C]**

Color Temp.	Color Code	Center coordinates		Ellipse radius (1step)		Angle
		x	y	a	b	
6500K	6500K	0.3123	0.3282	0.00223	0.00095	58.38
5700K	5700K	0.3287	0.3417	0.00274	0.00118	59.62
5000K	5000K	0.3447	0.3553	0.00274	0.00118	59.62
4500K	4500K	0.3611	0.3658	0.00313	0.00134	54
4000K	4000K	0.3818	0.3797	0.00313	0.00134	54
3500K	3500K	0.4073	0.3917	0.00317	0.00139	52.97
3000K	3000K	0.4338	0.403	0.00278	0.00136	53.17
2700K	2700K	0.4578	0.4101	0.00258	0.00137	57.28

**Reliability Test Items and Conditions:**

No.	Test Ite	Test Condition	Note	Number of Damaged
01	Thermal Shock	-25°C 15min ↑↓ 100°C 15min	300 cycle	0/22
02	Life Test	Ta=25°C	1000 hrs	0/22
03	Temperature Humidity Storage	Ta=85°C RH=85%	1000 hrs	0/22

**Connection diagram:**

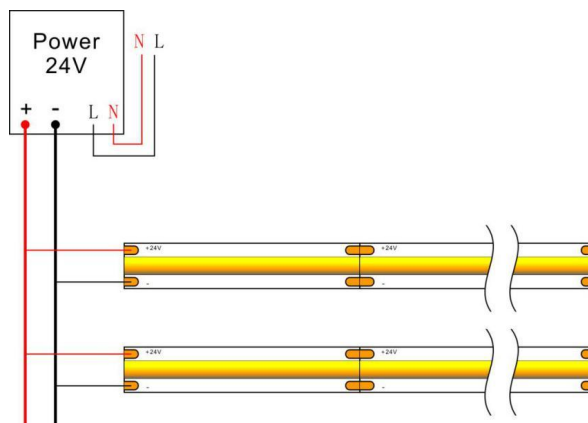

**Accessories:**

**Connector-Soldering FREE**

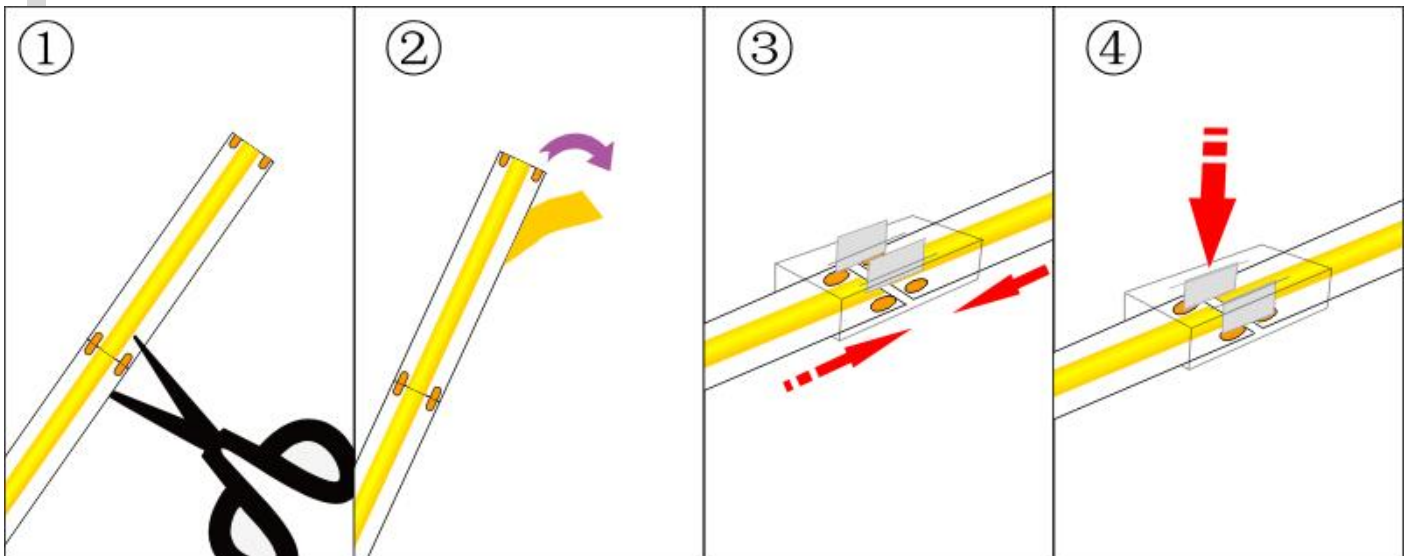
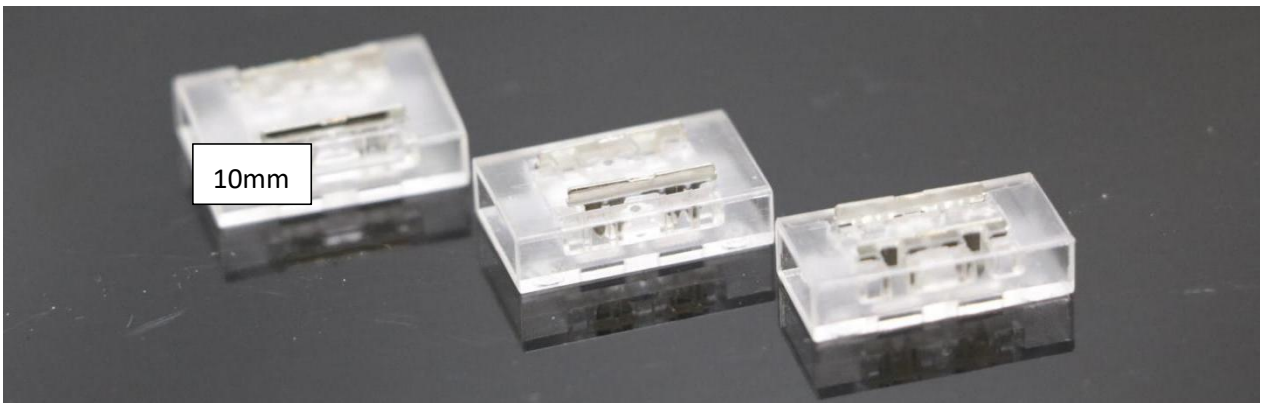

## Installation instruction:

- ❖ 1. Pls choose correct power supply for LED strips. The total power of the LED strip is about 80% of the power supply, and it cannot be fully loaded to ensure that the power supply works at the correct and stable voltage.
- ❖ 2. We suggest 5 meters/roll for the led strip.If it is over 5 meters length, the brightness of LED will vary greatly.If the customer can accept the case, length can be made over 5 meters/roll.
- ❖ 3. Adhesive tape on the back side of the strip,with its superior adhesive and weather resistance, and can be connected to any transparent glass, metal and plastic surface. But on some certain surfaces, such as cloth, wood, will affect its function and durability.Please test the adhesion of the led strip before installation.
- ❖ 4. Please pay special attention to the minimum bending diameter of the led strip is 60mm, so as to avoid direct or indirect damage to FPC and components on FPC, which may lead to damages of the strip.
- ❖ 5. In order to ensure waterproof and anti-corrosive function , after the power line is screwed into the connector, it is recommended to inject the connector with a single component of silica gel (or neutral glass glue, or waterproof grease) and cover the exposed copper wire of the power line for protection.
- ❖ 6. The non-waterproof led strip shall not be completely exposed for outdoor use. Do not touch or install the strip when it is charged.
- ❖ 7. It is recommended to use switch power supply that has passed relevant safety regulations (with short circuit protection, over voltage protection and over current protection).

## Installation requirement:

1. Pay attention to handling with care
2. Don't install the product in corrosion, flammable and explosive places;
3. It is strictly prohibited to use any acidic or alkaline adhesives to fix the product. Neutral adhesives are required;
4. In order to avoid the danger of electric shock, please cut off the power supply during process of installation, debugging and moving;
5. Ensure correct and reliable connection of all joints;
6. The product need anti-corrosion environment, such as, avoiding damp, water drop or other adverse elements.
7. The LED strip and accessories can't be squeezed or folded;
8. PCB conductive parts can't be damaged when installation;
9. Installation must conform to electrical safety standard. The LED strip can only be installed by Professionals;
10. Ensure power supply transform operating load with transformer;
11. When install on metal or conductor surface, insulation protection need to be provided to the contact area;
12. Observe positive and negative polarity, ensure correct connection to avoid damaging LED strip;
13. When installation, please prevent static electricity.